

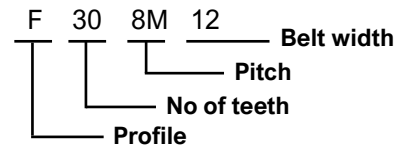

Item no. example:



These pulleys have been designed to fit the Falcon Pd belts, but they are also compatible with our Synchrochain and Poly chain belts. The pulleys are treated with a phosphated surface that gives a greater resistance against oxidizing agents. Available on request, pitches 8M and 14M. The pulleys are for mounting taper bush.

| 8M12 | | | | | | | | | | | | | | | |
|---------|-----------------|-----------------|-----------|---------|---------|---------|---------|--------|--------|--------|--------|------------|---------------|-------------|-----------|
| Profile | Number of teeth | Belt width [mm] | Execution | Do [mm] | Dy [mm] | Df [mm] | Di [mm] | W [mm] | H [mm] | Y [mm] | Z [mm] | Taper bush | Max bore [mm] | Weight [kg] | Material |
| CTD | 22 | 12 | 6 | 56,02 | 54,42 | 62 | - | 22 | - | 22 | - | 1008 | 25 | 0,42 | Cast Iron |
| CTD | 24 | 12 | 6 | 61,12 | 59,52 | 67 | - | 22 | - | 22 | - | 1108 | 28 | 0,43 | |
| CTD | 25 | 12 | 6 | 63,66 | 62,06 | 67 | - | 22 | - | 22 | - | 1108 | 28 | 0,43 | |
| CTD | 26 | 12 | 6 | 66,21 | 64,61 | 73 | - | 22 | - | 22 | - | 1108 | 28 | 0,49 | |
| CTD | 27 | 12 | 6 | 68,75 | 67,15 | 73 | - | 22 | - | 22 | - | 1108 | 28 | 0,53 | |
| CTD | 28 | 12 | 6 | 71,6 | 69,7 | 77 | - | 22 | - | 22 | - | 1108 | 28 | 0,6 | |
| CTD | 30 | 12 | 6 | 76,39 | 74,79 | 84 | - | 22 | - | 22 | 5 | 1108 | 28 | 0,67 | |
| CTD | 32 | 12 | 2 | 81,49 | 79,89 | 88 | - | 20 | 66 | 25 | 5 | 1210 | 35 | 0,77 | Steel |
| CTD | 34 | 12 | 2 | 86,58 | 84,98 | 94 | - | 20 | 72 | 25 | 5 | 1610 | 42 | 0,88 | |
| CTD | 36 | 12 | 2 | 91,67 | 90,07 | 98 | - | 20 | 75 | 25 | 5 | 1610 | 42 | 1,02 | |
| CTD | 37 | 12 | 2 | 94,22 | 92,62 | 100 | - | 20 | 77 | 25 | 5 | 1610 | 42 | 1,11 | |
| CTD | 38 | 12 | 2 | 96,77 | 95,17 | 104 | - | 20 | 82 | 25 | 5 | 1610 | 42 | 1,15 | |
| CTD | 40 | 12 | 2 | 101,86 | 100,26 | 108 | - | 20 | 89 | 25 | 5 | 1610 | 42 | 1,19 | |
| CTD | 41 | 12 | 2 | 104,41 | 102,81 | 111 | - | 20 | 89 | 25 | 5 | 1610 | 42 | 1,23 | |
| CTD | 42 | 12 | 2 | 106,95 | 105,35 | 113 | - | 20 | 91 | 25 | 5 | 1610 | 42 | 1,38 | |
| CTD | 44 | 12 | 2 | 112,05 | 110,45 | 121 | - | 20 | 104 | 32 | 12 | 2012 | 50 | 1,62 | |
| CTD | 45 | 12 | 2 | 114,59 | 112,99 | 121 | - | 20 | 104 | 32 | 12 | 2012 | 50 | 1,76 | |
| CTD | 48 | 12 | 2 | 122,23 | 120,63 | 129 | - | 20 | 105 | 32 | 12 | 2012 | 50 | 2,16 | |
| CTD | 50 | 12 | 2 | 127,32 | 125,72 | 131 | - | 20 | 105 | 32 | 12 | 2012 | 50 | 2,16 | |
| CTD | 56 | 12 | 2 | 142,6 | 141 | 149 | - | 20 | 105 | 32 | 12 | 2012 | 50 | 2,83 | |
| CTD | 60 | 12 | 2 | 152,79 | 151,19 | 158 | - | 20 | 110 | 32 | 12 | 2012 | 50 | 3,24 | |
| CTD | 64 | 12 | 9 | 162,97 | 161,37 | 168 | 140 | 20 | 110 | 32 | 12 | 2012 | 50 | 3,51 | |
| CTD | 67 | 12 | 9 | 170,60 | 169,00 | 175 | 147 | 20 | 110 | 32 | 12 | 2012 | 50 | 3,82 | |
| CTD | 72 | 12 | 9 | 183,35 | 181,75 | 191 | 158 | 20 | 110 | 32 | 12 | 2012 | 50 | 4,11 | |
| CTD | 75 | 12 | 9 | 190,99 | 189,39 | 202 | 164 | 20 | 110 | 32 | 12 | 2012 | 50 | 4,57 | |
| CTD | 80 | 12 | 9 | 203,72 | 202,12 | 216 | 178 | 20 | 110 | 32 | 12 | 2012 | 50 | 5,13 | |
| CTD | 90 | 12 | 9A | 229,18 | 227,58 | - | 204 | 20 | 110 | 32 | 12 | 2012 | 50 | 6,37 | |

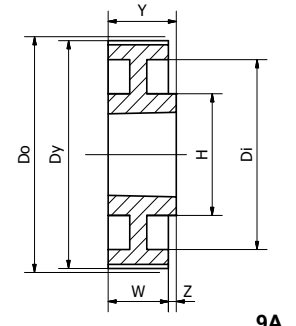
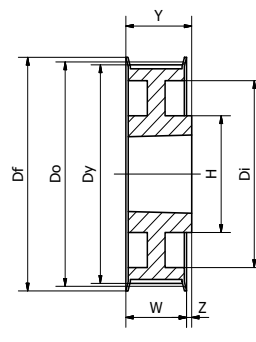
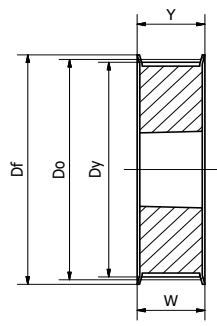
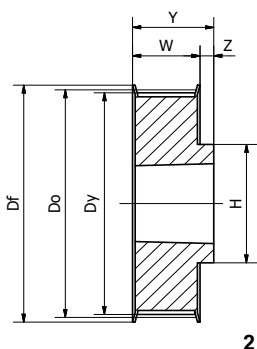

| 8M21 | | | | | | | | | | | | | | | |
|---------|-----------------|-----------------|-----------|---------|---------|---------|---------|--------|--------|--------|--------|------------|---------------|-------------|-----------|
| Profile | Number of teeth | Belt width [mm] | Execution | Do [mm] | Dy [mm] | Df [mm] | Di [mm] | W [mm] | H [mm] | Y [mm] | Z [mm] | Taper bush | Max bore [mm] | Weight [kg] | Material |
| CTD | 22 | 21 | 4 | 56,02 | 54,42 | 62 | 38 | 30 | - | 22 | 8 | 1008 | 25 | 0,57 | Cast Iron |
| CTD | 25 | 21 | 4 | 63,66 | 62,06 | 67 | 45 | 30 | - | 22 | 8 | 1108 | 28 | 0,6 | |
| CTD | 28 | 21 | 4 | 71,6 | 69,7 | 77 | 52 | 30 | - | 22 | 8 | 1108 | 28 | 0,75 | |
| CTD | 30 | 21 | 4 | 76,39 | 74,79 | 84 | 58 | 30 | - | 25 | 5 | 1610 | 42 | 0,83 | Steel |
| CTD | 32 | 21 | 4 | 81,49 | 79,89 | 88 | 63 | 30 | - | 25 | 5 | 1610 | 42 | 0,97 | |
| CTD | 34 | 21 | 4 | 86,58 | 84,98 | 94 | 68 | 30 | - | 25 | 5 | 1610 | 42 | 0,12 | Cast Iron |
| CTD | 36 | 21 | 4 | 91,67 | 90,07 | 98 | 73 | 30 | - | 25 | 5 | 1610 | 42 | 1,29 | |
| CTD | 38 | 21 | 4 | 96,77 | 95,17 | 104 | 78 | 30 | - | 25 | 5 | 1610 | 42 | 1,34 | |
| CTD | 40 | 21 | 4 | 101,86 | 100,26 | 108 | 83 | 30 | - | 25 | 5 | 1610 | 42 | 1,5 | |
| CTD | 41 | 21 | 4 | 104,41 | 102,81 | 108 | 86 | 30 | - | 25 | 5 | 1610 | 42 | 1,59 | |
| CTD | 42 | 21 | 4 | 106,70 | 105,10 | 111 | - | 30 | - | 32 | 5 | 1610 | 42 | 1,71 | |
| CTD | 44 | 21 | 1 | 112,05 | 110,45 | 121 | - | 30 | 104 | 32 | 1 | 2012 | 50 | 1,92 | |
| CTD | 45 | 21 | 1 | 114,59 | 112,99 | 121 | - | 30 | 104 | 32 | 1 | 2012 | 50 | 2,03 | |
| CTD | 48 | 21 | 1 | 122,23 | 120,63 | 129 | - | 30 | 105 | 32 | 1 | 2012 | 50 | 2,24 | |
| CTD | 50 | 21 | 1 | 127,32 | 125,72 | 131 | - | 30 | 105 | 32 | 1 | 2012 | 50 | 2,42 | |
| CTD | 56 | 21 | 1 | 142,6 | 141,00 | 149 | - | 30 | 105 | 32 | 1 | 2012 | 50 | 3,2 | |
| CTD | 60 | 21 | 1 | 152,79 | 151,19 | 158 | - | 30 | 110 | 45 | 7,5 | 2517 | 65 | 4,66 | |
| CTD | 64 | 21 | 11 | 162,97 | 161,37 | 168 | 138 | 30 | 120 | 45 | 7,5 | 2517 | 65 | 5,28 | |
| CTD | 67 | 21 | 11 | 170,60 | 169,00 | 175 | 145 | 30 | 120 | 45 | 7,5 | 2517 | 65 | 5,87 | |
| CTD | 72 | 21 | 11 | 183,35 | 181,75 | 191 | 158 | 30 | 120 | 45 | 7,5 | 2517 | 65 | 6,22 | |
| CTD | 75 | 21 | 11 | 190,99 | 189,39 | 202 | 165 | 30 | 120 | 45 | 7,5 | 2517 | 65 | 6,77 | |
| CTD | 80 | 21 | 11 | 203,72 | 202,12 | 216 | 178 | 30 | 160 | 45 | 7,5 | 3020 | 75 | 7,61 | |
| CTD | 90 | 21 | 11 | 229,18 | 227,58 | - | 146 | 30 | 160 | 45 | 7,5 | 3020 | 75 | 8,57 | |
| CTD | 112 | 21 | 11B | 285,21 | 283,61 | - | 260 | 30 | 160 | 45 | 7,5 | 3020 | 75 | 12,5 | |
| CTD | 140 | 21 | 11B | 356,51 | 354,91 | - | 331 | 30 | 160 | 51 | 7,5 | 3020 | 75 | 12,79 | |
| CTD | 144 | 21 | 11B | 641,71 | 638,92 | - | 341 | 30 | 160 | 51 | 7,5 | 3020 | 75 | 15,3 | |

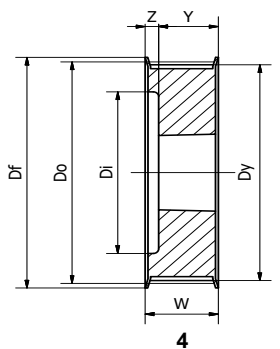
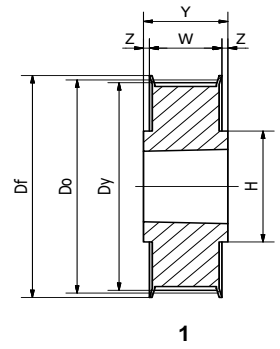

| 8M36 | | | | | | | | | | | | | | | |
|---------|-----------------|-----------------|-----------|---------|---------|---------|---------|--------|--------|--------|--------|------------|---------------|-------------|-----------|
| Profile | Number of teeth | Belt width [mm] | Execution | Do [mm] | Dy [mm] | Df [mm] | Di [mm] | W [mm] | H [mm] | Y [mm] | Z [mm] | Taper bush | Max bore [mm] | Weight [kg] | Material |
| CTD | 25 | 36 | 4C | 63,66 | 62,06 | 67 | - | 45 | 49 | 55 | 10 | - | - | 1,02 | Steel |
| CTD | 28 | 36 | 4C | 71,6 | 69,7 | 77 | - | 45 | 49 | 55 | 10 | - | - | 1,11 | |
| CTD | 30 | 36 | 4 | 76,39 | 74,79 | 84 | 58 | 45 | - | 38 | 7 | 1615 | 42 | 1,22 | |
| CTD | 32 | 36 | 4 | 81,49 | 79,89 | 88 | 60 | 45 | - | 38 | 7 | 1615 | 42 | 1,45 | Cast Iron |
| CTD | 34 | 36 | 4 | 86,58 | 84,98 | 94 | 66 | 45 | - | 38 | 7 | 1615 | 42 | 1,66 | |
| CTD | 36 | 36 | 4 | 91,67 | 90,07 | 98 | 68 | 45 | - | 38 | 7 | 1615 | 42 | 1,9 | Cast Iron |
| CTD | 38 | 36 | 4 | 96,77 | 95,17 | 104 | 75 | 45 | - | 38 | 7 | 1615 | 42 | 2,21 | |
| CTD | 40 | 36 | 5 | 101,86 | 100,26 | 108 | 80 | 45 | - | 32 | 6,5 | 2012 | 50 | 2,36 | |
| CTD | 41 | 36 | 5 | 104,41 | 102,81 | 108 | 80 | 45 | - | 32 | 6,5 | 2012 | 50 | 2,56 | |
| CTD | 42 | 36 | 5 | 106,95 | 105,35 | 111 | 80 | 45 | - | 32 | 6,5 | 2012 | 50 | 2,98 | |
| CTD | 44 | 36 | 5 | 112,05 | 110,45 | 121 | 90 | 45 | - | 32 | 6,5 | 2012 | 50 | 3,01 | |
| CTD | 45 | 36 | 5 | 114,59 | 112,99 | 121 | 90 | 45 | - | 32 | 6,5 | 2012 | 50 | 3,07 | |
| CTD | 48 | 36 | 5 | 122,23 | 120,63 | 129 | 98 | 45 | - | 32 | 6,5 | 2012 | 50 | 3,3 | |
| CTD | 50 | 36 | 5 | 127,32 | 125,72 | 131 | 103 | 45 | - | 32 | 6,5 | 2012 | 50 | 3,58 | |
| CTD | 56 | 36 | 6 | 142,6 | 141 | 149 | - | 45 | - | 45 | - | 2517 | 65 | 4,348 | |
| CTD | 60 | 36 | 6 | 152,79 | 151,19 | 158 | - | 45 | - | 45 | - | 2517 | 65 | 5,3 | |
| CTD | 64 | 36 | 7 | 162,97 | 161,37 | 168 | 138 | 45 | 120 | 45 | - | 2517 | 65 | 6,19 | |
| CTD | 67 | 36 | 7 | 170,60 | 169,00 | 175 | 145 | 45 | 120 | 45 | - | 2517 | 65 | 6,92 | |
| CTD | 72 | 36 | 7 | 183,35 | 181,75 | 191 | 158 | 45 | 120 | 45 | - | 2517 | 65 | 7,89 | |
| CTD | 75 | 36 | 11 | 190,99 | 189,39 | 202 | 165 | 45 | 160 | 51 | 3 | 3020 | 75 | 8,72 | |
| CTD | 80 | 36 | 11 | 203,72 | 202,12 | 216 | 178 | 45 | 160 | 51 | 3 | 3020 | 75 | 9,96 | |
| CTD | 90 | 36 | 11A | 229,18 | 227,58 | - | 204 | 45 | 160 | 51 | 3 | 3020 | 75 | 10,41 | |
| CTD | 112 | 36 | 11B | 285,21 | 283,61 | - | 260 | 45 | 160 | 51 | 3 | 3020 | 75 | 14,01 | |
| CTD | 140 | 36 | 11B | 356,51 | 354,91 | - | 331 | 45 | 160 | 51 | 3 | 3020 | 75 | 11,98 | |
| CTD | 144 | 36 | 11B | 641,71 | 638,92 | - | 341 | 45 | 160 | 51 | 3 | 3020 | 75 | 18,59 | |
| CTD | 168 | 36 | 11B | 427,81 | 426,21 | - | 402 | 45 | 160 | 51 | 3 | 3020 | 75 | 23,91 | |
| CTD | 192 | 36 | 11B | 488,92 | 487,32 | - | 462 | 45 | 160 | 51 | 3 | 3020 | 75 | 26,53 | |

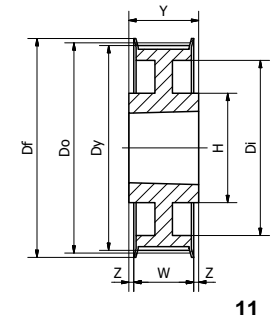
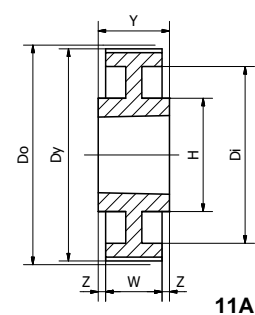
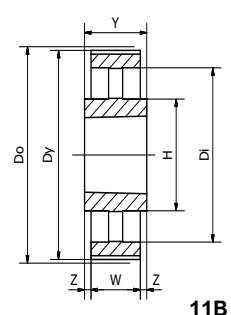
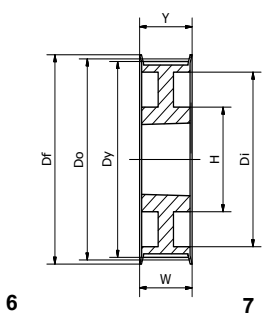
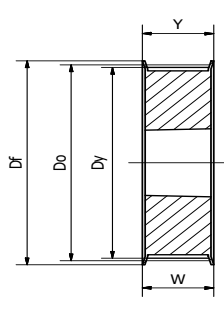
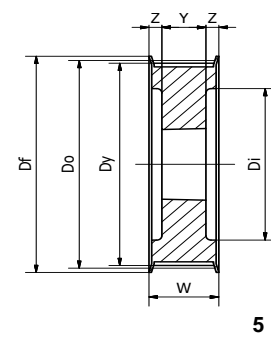
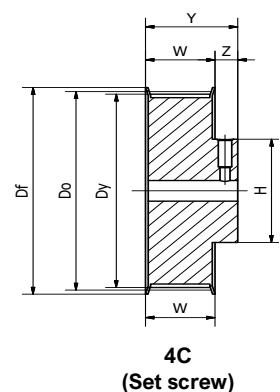

| 8M62 | | | | | | | | | | | | | | | |
|---------|-----------------|-----------------|-----------|---------|---------|---------|---------|--------|--------|--------|--------|------------|---------------|-------------|-----------|
| Profile | Number of teeth | Belt width [mm] | Execution | Do [mm] | Dy [mm] | Df [mm] | Di [mm] | W [mm] | H [mm] | Y [mm] | Z [mm] | Taper bush | Max bore [mm] | Weight [kg] | Material |
| CTD | 30 | 62 | 4 | 76,39 | 74,79 | 84 | 58 | 72 | - | 38 | 17 | 1615 | 42 | 2,45 | Steel |
| CTD | 32 | 62 | 4 | 81,49 | 79,89 | 88 | 60 | 72 | - | 38 | 17 | 1615 | 42 | 2,82 | |
| CTD | 34 | 62 | 5 | 86,58 | 84,98 | 94 | 66 | 72 | - | 38 | 17 | 1615 | 42 | 3,17 | Cast Iron |
| CTD | 36 | 62 | 5 | 91,67 | 90,07 | 98 | 68 | 72 | - | 38 | 17 | 1615 | 42 | 3,52 | |
| CTD | 38 | 62 | 5 | 96,7 | 95,17 | 104 | 75 | 72 | - | 38 | 17 | 1615 | 42 | 3,91 | |
| CTD | 40 | 62 | 5 | 101,86 | 100,26 | 108 | 80 | 72 | - | 32 | 20 | 2012 | 50 | 3,76 | Steel |
| CTD | 41 | 62 | 5 | 104,41 | 102,81 | 108 | 80 | 72 | - | 32 | 20 | 2012 | 50 | 3,82 | |
| CTD | 42 | 62 | 5 | 106,95 | 105,35 | 111 | 80 | 72 | - | 32 | 20 | 2012 | 50 | 4,11 | Cast Iron |
| CTD | 44 | 62 | 5 | 112,05 | 110,45 | 121 | 90 | 72 | - | 32 | 20 | 2012 | 50 | 4,52 | |
| CTD | 45 | 62 | 5 | 114,59 | 112,99 | 121 | 92 | 72 | - | 32 | 20 | 2012 | 50 | 4,88 | Steel |
| CTD | 48 | 62 | 5 | 122,23 | 120,63 | 129 | 100 | 72 | - | 45 | 13,5 | 2517 | 65 | 5,52 | |
| CTD | 50 | 62 | 5 | 127,32 | 125,72 | 131 | 105 | 72 | - | 45 | 13,5 | 2517 | 65 | 6,03 | Cast Iron |
| CTD | 56 | 62 | 5 | 142,6 | 141 | 149 | 120 | 72 | - | 45 | 13,5 | 2517 | 65 | 5,43 | |
| CTD | 60 | 62 | 5 | 152,79 | 151,19 | 158 | 128 | 72 | - | 45 | 13,5 | 2517 | 65 | 6,33 | |
| CTD | 64 | 62 | 5 | 162,97 | 161,37 | 168 | 138 | 72 | - | 45 | 13,5 | 2517 | 65 | 7,11 | |
| CTD | 67 | 62 | 5 | 170,60 | 169,00 | 175 | 145 | 72 | - | 45 | 13,5 | 2517 | 65 | 8,2 | |
| CTD | 72 | 62 | 5 | 183,35 | 181,75 | 191 | 158 | 72 | - | 51 | 10,5 | 3020 | 75 | 8,98 | |
| CTD | 75 | 62 | 5 | 190,99 | 189,39 | 202 | 165 | 72 | - | 51 | 10,5 | 3020 | 75 | 9,99 | |
| CTD | 80 | 62 | 8 | 203,72 | 202,12 | 216 | 178 | 72 | 160 | 51 | 10,5 | 3020 | 75 | 11,44 | |
| CTD | 90 | 62 | 8A | 229,18 | 227,58 | - | 204 | 72 | 160 | 51 | 10,5 | 3020 | 75 | 14,94 | |
| CTD | 112 | 62 | 8B | 285,21 | 283,61 | - | 260 | 72 | 160 | 51 | 105 | 3020 | 75 | 14,94 | |
| CTD | 140 | 62 | 11B | 356,51 | 354,91 | - | 331 | 72 | 146 | 76 | 2 | 3030 | 75 | 24,77 | |
| CTD | 144 | 62 | 11B | 641,71 | 638,92 | - | 341 | 72 | 146 | 76 | 2 | 3030 | 75 | 25,8 | |
| CTD | 168 | 62 | 11B | 427,81 | 426,21 | - | 402 | 72 | 146 | 76 | 2 | 3030 | 75 | 28,39 | |
| CTD | 192 | 62 | 11B | 488,92 | 487,32 | - | 462 | 72 | 146 | 76 | 2 | 3030 | 75 | 32,18 | |

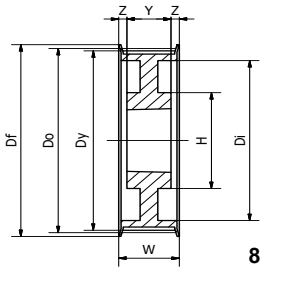
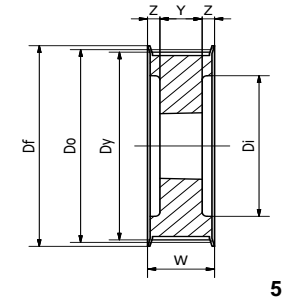
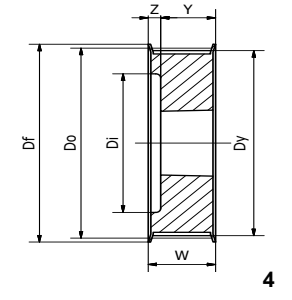
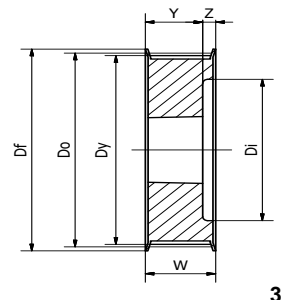
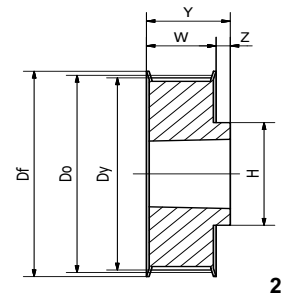

| 14M20 | | | | | | | | | | | | | | | |
|---------|-----------------|-----------------|-----------|---------|---------|---------|---------|--------|--------|--------|--------|------------|---------------|-------------|-----------|
| Profile | Number of teeth | Belt width [mm] | Execution | Do [mm] | Dy [mm] | Df [mm] | Di [mm] | W [mm] | H [mm] | Y [mm] | Z [mm] | Taper bush | Max bore [mm] | Weight [kg] | Material |
| CTD | 28 | 20 | 3 | 124,78 | 121,98 | 134 | 98 | 33 | - | 32 | 1 | 2012 | 50 | 2,46 | Cast Iron |
| CTD | 29 | 20 | 3 | 129,23 | 126,43 | 134 | 100 | 33 | - | 32 | 1 | 2012 | 50 | 2,68 | |
| CTD | 30 | 20 | 3 | 133,69 | 130,89 | 142 | 100 | 33 | - | 32 | 1 | 2012 | 50 | 2,85 | |
| CTD | 32 | 20 | 3 | 142,6 | 139,8 | 150 | 104 | 33 | - | 32 | 1 | 2012 | 50 | 3,26 | |
| CTD | 34 | 20 | 2 | 151,52 | 148,72 | 158 | - | 33 | 125 | 45 | 12 | 2517 | 65 | 4,35 | |
| CTD | 36 | 20 | 2 | 160,43 | 157,53 | 166 | - | 33 | 125 | 45 | 12 | 2517 | 65 | 5,05 | |
| CTD | 38 | 20 | 2 | 169,34 | 166,54 | 177 | - | 33 | 125 | 45 | 12 | 2517 | 65 | 5,39 | |
| CTD | 40 | 20 | 2 | 178,25 | 175,45 | 186 | - | 33 | 125 | 45 | 12 | 2517 | 65 | 5,97 | |
| CTD | 44 | 20 | 2 | 196,08 | 193,28 | 209 | - | 33 | 160 | 51 | 18 | 3020 | 75 | 8,03 | |
| CTD | 48 | 20 | 2 | 213,9 | 211,11 | 216 | - | 33 | 160 | 51 | 18 | 3020 | 75 | 9,48 | |
| CTD | 50 | 20 | 2 | 222,82 | 220,02 | 232 | - | 33 | 160 | 51 | 18 | 3020 | 75 | 10,13 | |
| CTD | 56 | 20 | 11 | 249,55 | 246,76 | 261 | 207 | 33 | 160 | 51 | 9 | 3020 | 75 | 10,81 | |
| CTD | 60 | 20 | 11 | 267,38 | 264,58 | 274 | 224 | 33 | 160 | 51 | 9 | 3020 | 75 | 12,59 | |
| CTD | 64 | 20 | 11 | 285,21 | 282,41 | 288 | 243 | 33 | 160 | 51 | 9 | 3020 | 75 | 13,84 | |
| CTD | 72 | 20 | 11A | 320,86 | 318,06 | - | 279 | 33 | 160 | 51 | 9 | 3020 | 75 | 15,51 | |
| CTD | 80 | 20 | 11B | 356,51 | 353,71 | - | 314 | 33 | 160 | 51 | 9 | 3020 | 75 | 18,13 | |
| CTD | 90 | 20 | 11B | 401,07 | 398,27 | - | 259 | 33 | 160 | 51 | 9 | 3020 | 75 | 19,47 | |
| CTD | 112 | 20 | 11B | 499,11 | 496,31 | - | 457 | 33 | 160 | 51 | 9 | 3020 | 75 | 24,25 | |
| CTD | 140 | 20 | 11B | 623,89 | 621,09 | - | 581 | 33 | 160 | 51 | 9 | 3020 | 75 | 20,96 | |
| CTD | 144 | 20 | 11B | 641,71 | 638,92 | - | 600 | 33 | 160 | 51 | 9 | 3020 | 75 | - | |
| CTD | 168 | 20 | 11B | 748,66 | 745,87 | - | 705 | 33 | 160 | 51 | 9 | 3020 | 75 | 24,36 | |
| CTD | 192 | 20 | 11B | 855,62 | 852,82 | - | 812 | 33 | 178 | 51 | 9 | 3535 | 90 | - | |
| CTD | 216 | 20 | 11B | 962,57 | 959,77 | - | 920 | 33 | 178 | 51 | 9 | 3535 | 90 | - | |
| CTD | 264 | 20 | 11B | 1176,47 | 1173,67 | - | 1133 | 33 | 178 | 51 | 9 | 3535 | 90 | - | |

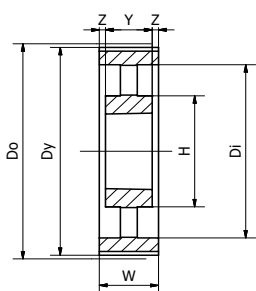

8B

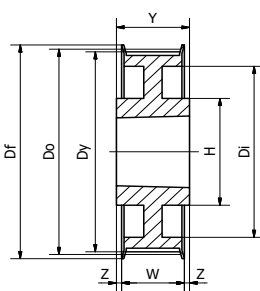

11

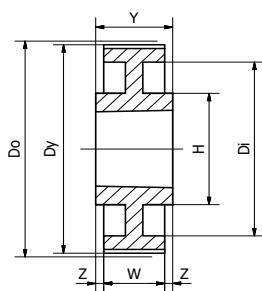

11B

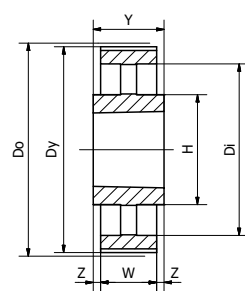

11A

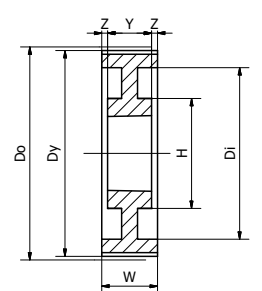

8A

| 14M37 | | | | | | | | | | | | | | | |
|---------|-----------------|-----------------|-----------|---------|---------|---------|---------|--------|--------|--------|--------|------------|---------------|-------------|-----------|
| Profile | Number of teeth | Belt width [mm] | Execution | Do [mm] | Dy [mm] | Df [mm] | Di [mm] | W [mm] | H [mm] | Y [mm] | Z [mm] | Taper bush | Max bore [mm] | Weight [kg] | Material |
| CTD | 28 | 37 | 5 | 124,78 | 121,98 | 134 | 98 | 51 | - | 32 | 9,5 | 2012 | 50 | 2,97 | Cast Iron |
| CTD | 30 | 37 | 5 | 133,69 | 130,89 | 142 | 100 | 51 | - | 32 | 9,5 | 2012 | 50 | 3,81 | |
| CTD | 32 | 37 | 5 | 142,6 | 139,8 | 150 | 104 | 51 | - | 32 | 9,5 | 2012 | 50 | 4,53 | |
| CTD | 34 | 37 | 5 | 151,52 | 148,72 | 158 | 110 | 51 | - | 45 | 3 | 2517 | 65 | 5,06 | |
| CTD | 36 | 37 | 5 | 160,43 | 157,53 | 166 | 120 | 51 | - | 45 | 3 | 2517 | 65 | 5,92 | |
| CTD | 38 | 37 | 5 | 169,34 | 166,54 | 177 | 130 | 51 | - | 45 | 3 | 2517 | 65 | 6,51 | |
| CTD | 40 | 37 | 5 | 178,25 | 175,45 | 186 | 138 | 51 | - | 45 | 3 | 2517 | 65 | 7,31 | |
| CTD | 44 | 37 | 6 | 196,08 | 193,28 | 209 | - | 51 | - | 51 | - | 3020 | 75 | 9,44 | |
| CTD | 48 | 37 | 6 | 213,9 | 211,11 | 216 | - | 51 | - | 51 | - | 3020 | 75 | 11,44 | |
| CTD | 50 | 37 | 6 | 222,82 | 220,02 | 232 | - | 51 | - | 51 | - | 3020 | 75 | 12,62 | |
| CTD | 56 | 37 | 7 | 249,55 | 246,76 | 261 | 207 | 51 | 160 | 51 | - | 3020 | 75 | 12,7 | |
| CTD | 60 | 37 | 7 | 267,38 | 264,58 | 274 | 224 | 51 | 160 | 51 | - | 3020 | 75 | 14,23 | |
| CTD | 64 | 37 | 7 | 285,21 | 282,41 | 288 | 243 | 51 | 160 | 51 | - | 3020 | 75 | 15,58 | |
| CTD | 72 | 37 | 7A | 320,86 | 318,06 | - | 279 | 51 | 160 | 51 | - | 3020 | 75 | 17,25 | |
| CTD | 80 | 37 | 7B | 356,51 | 353,71 | - | 314 | 51 | 160 | 51 | - | 3020 | 75 | 20,32 | |
| CTD | 90 | 37 | 7B | 401,07 | 398,27 | - | 359 | 51 | 160 | 51 | - | 3020 | 75 | 29,85 | |
| CTD | 112 | 37 | 11B | 499,11 | 496,31 | - | 457 | 51 | 178 | 51 | 19 | 3020 | 75 | 27,43 | |
| CTD | 140 | 37 | 11B | 623,89 | 621,09 | - | 581 | 51 | 178 | 51 | 19 | 3020 | 75 | 33,55 | |
| CTD | 144 | 37 | 11B | 641,71 | 638,92 | - | 600 | 51 | 178 | 51 | 19 | 3020 | 75 | 48,62 | |
| CTD | 168 | 37 | 11B | 748,66 | 745,87 | - | 705 | 51 | 178 | 51 | 19 | 3020 | 75 | 64,5 | |
| CTD | 192 | 37 | 11B | 855,61 | 852,82 | - | 812 | 51 | 178 | 89 | 19 | 3535 | 90 | 83,82 | |
| CTD | 216 | 37 | 11B | 962,57 | 959,77 | - | 920 | 51 | 215 | 102 | 25,5 | 4040 | 100 | - | |
| CTD | 264 | 37 | 11B | 1176,47 | 1173,67 | - | 1133 | 51 | 215 | 102 | 25,5 | 4040 | 100 | - | |

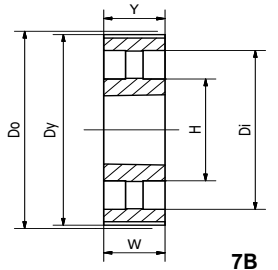
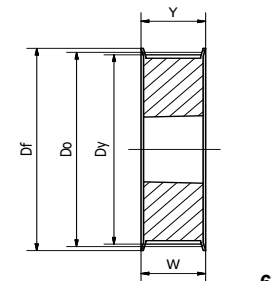
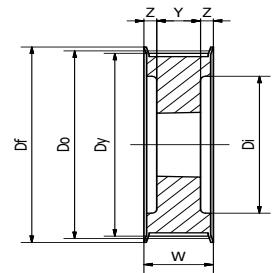
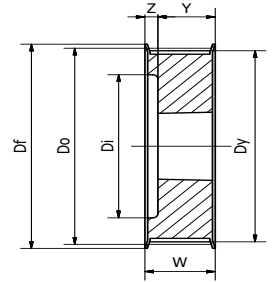
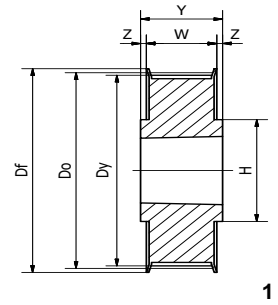

| 14M68 | | | | | | | | | | | | | | | |
|---------|-----------------|-----------------|-----------|---------|---------|---------|---------|--------|--------|--------|--------|------------|---------------|-------------|-----------|
| Profile | Number of teeth | Belt width [mm] | Execution | Do [mm] | Dy [mm] | Df [mm] | Di [mm] | W [mm] | H [mm] | Z [mm] | Y [mm] | Taper bush | Max bore [mm] | Weight [kg] | Material |
| CTD | 28 | 68 | 5 | 124,78 | 121,98 | 134 | 98 | 84 | - | 19,5 | 45 | 2517 | 65 | 5,1 | Steel |
| CTD | 29 | 68 | 5 | 129,23 | 126,43 | 134 | 100 | 84 | - | 19,5 | 45 | 2517 | 65 | 5,55 | Cast Iron |
| CTD | 30 | 68 | 5 | 133,69 | 130,89 | 142 | 100 | 84 | - | 19,5 | 45 | 2517 | 65 | 5,85 | |
| CTD | 32 | 68 | 5 | 142,6 | 139,8 | 150 | 104 | 84 | - | 19,5 | 45 | 2517 | 65 | 6,05 | GS400 |
| CTD | 34 | 68 | 4 | 151,52 | 148,72 | 158 | 110 | 84 | - | 19,5 | 45 | 2517 | 65 | 6,25 | |
| CTD | 36 | 68 | 5 | 160,43 | 157,53 | 166 | 120 | 84 | - | 19,5 | 51 | 3020 | 75 | 6,68 | Cast Iron |
| CTD | 38 | 68 | 5 | 169,34 | 166,54 | 177 | 130 | 84 | - | 19,5 | 51 | 3020 | 75 | 7,46 | |
| CTD | 40 | 68 | 5 | 178,25 | 175,45 | 186 | 138 | 84 | - | 16,5 | 51 | 3020 | 75 | 7,81 | |
| CTD | 44 | 68 | 5 | 196,08 | 193,28 | 209 | 154 | 84 | - | 4 | 76 | 3030 | 75 | 11,54 | |
| CTD | 48 | 68 | 5 | 213,9 | 211,11 | 216 | 138 | 84 | - | 4 | 76 | 3030 | 75 | 13,74 | |
| CTD | 50 | 68 | 1 | 222,82 | 220,02 | 232 | - | 84 | 178 | 2,5 | 89 | 3535 | 90 | 16,63 | |
| CTD | 56 | 68 | 1 | 249,55 | 246,76 | 261 | - | 84 | 178 | 2,5 | 89 | 3535 | 90 | 21,15 | |
| CTD | 60 | 68 | 11 | 267,38 | 264,58 | 274 | 224 | 84 | 178 | 2,5 | 89 | 3535 | 90 | 24,28 | |
| CTD | 64 | 68 | 11 | 285,21 | 282,41 | 288 | 243 | 84 | 178 | 2,5 | 89 | 3535 | 90 | 27,86 | |
| CTD | 72 | 68 | 11A | 320,86 | 318,06 | - | 279 | 84 | 178 | 2,5 | 89 | 3535 | 90 | 25,74 | |
| CTD | 80 | 68 | 11B | 356,51 | 353,71 | - | 314 | 84 | 178 | 2,5 | 89 | 3535 | 90 | 29,86 | |
| CTD | 90 | 68 | 11B | 401,07 | 398,27 | - | 359 | 84 | 178 | 2,5 | 89 | 3535 | 90 | 31,24 | |
| CTD | 112 | 68 | 11B | 499,11 | 496,31 | - | 453 | 84 | 178 | 2,5 | 89 | 3535 | 90 | 39,25 | |
| CTD | 140 | 68 | 11B | 623,89 | 621,09 | - | 581 | 84 | 178 | 2,5 | 89 | 3535 | 90 | 40,87 | |
| CTD | 168 | 68 | 11B | 748,66 | 745,87 | - | 705 | 84 | 178 | 2,5 | 89 | 3535 | 90 | 73,3 | |
| CTD | 192 | 68 | 11B | 855,61 | 852,82 | - | 812 | 84 | 215 | 9 | 102 | 4040 | 100 | 94,21 | |
| CTD | 216 | 68 | 11B | 962,57 | 959,77 | - | 920 | 84 | 267 | 21,5 | 127 | 5050 | 100 | - | |
| CTD | 264 | 68 | 11B | 1176,47 | 1176,47 | - | 1133 | 84 | 267 | 21,5 | 127 | 5050 | 100 | - | |

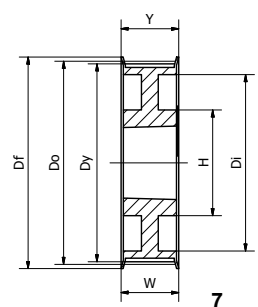
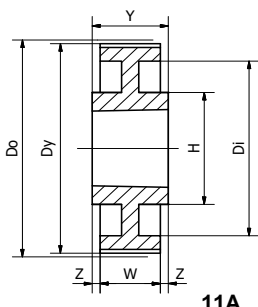
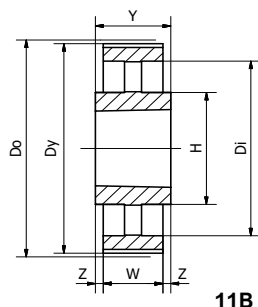
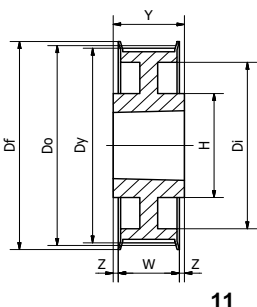
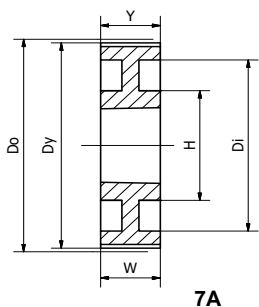

| 14M90 | | | | | | | | | | | | | | | |
|---------|-----------------|-----------------|-----------|---------|---------|---------|---------|--------|--------|--------|--------|------------|---------------|-------------|-----------|
| Profile | Number of teeth | Belt width [mm] | Execution | Do [mm] | Dy [mm] | Df [mm] | Di [mm] | W [mm] | H [mm] | Z [mm] | Y [mm] | Taper bush | Max bore [mm] | Weight [kg] | Material |
| CTD | 28 | 90 | 4C | 124,78 | 121,98 | 134 | - | 106 | 100 | 15 | 121 | - | - | - | Cast Iron |
| CTD | 29 | 90 | 4C | 129,23 | 126,43 | 134 | - | 106 | 100 | 15 | 121 | - | - | - | |
| CTD | 30 | 90 | 4C | 133,69 | 130,89 | 142 | - | 106 | 105 | 15 | 121 | - | - | - | |
| CTD | 32 | 90 | 4C | 142,6 | 139,8 | 150 | - | 106 | 110 | 15 | 121 | - | - | 6,05 | |
| CTD | 34 | 90 | 4 | 151,52 | 148,72 | 158 | 110 | 106 | - | 30,5 | 51 | 3020 | 65 | 6,25 | GS400 |
| CTD | 36 | 90 | 5 | 160,43 | 157,53 | 166 | 120 | 106 | - | 27,5 | 51 | 3020 | 75 | 8,18 | |
| CTD | 38 | 90 | 5 | 169,34 | 166,54 | 177 | 130 | 106 | - | 27,5 | 51 | 3020 | 75 | 9,73 | |
| CTD | 40 | 90 | 5 | 178,25 | 175,45 | 186 | 138 | 106 | - | 27,5 | 51 | 3020 | 75 | 10,29 | |
| CTD | 44 | 90 | 5 | 196,08 | 193,28 | 209 | 154 | 106 | - | 15 | 76 | 3030 | 75 | 11,92 | |
| CTD | 48 | 90 | 5 | 213,9 | 211,11 | 216 | 172 | 106 | - | 15 | 76 | 3030 | 75 | 16,76 | |
| CTD | 50 | 90 | 5 | 222,82 | 220,02 | 232 | 181 | 106 | - | 8,5 | 89 | 3535 | 90 | 18,38 | |
| CTD | 56 | 90 | 5 | 249,55 | 246,76 | 261 | 207 | 106 | - | 8,5 | 89 | 3535 | 90 | 23,46 | |
| CTD | 60 | 90 | 5 | 267,38 | 264,58 | 274 | 225 | 106 | - | 8,5 | 89 | 3535 | 90 | 26,53 | |
| CTD | 64 | 90 | 8 | 285,21 | 282,41 | 288 | 243 | 106 | 178 | 8,5 | 89 | 3535 | 90 | 30,3 | |
| CTD | 72 | 90 | 8A | 320,86 | 318,06 | - | 279 | 106 | 178 | 8,5 | 89 | 3535 | 90 | 26,36 | |
| CTD | 80 | 90 | 8B | 356,51 | 353,71 | - | 314 | 106 | 178 | 8,5 | 89 | 3535 | 90 | 35,61 | |
| CTD | 90 | 90 | 8B | 401,07 | 398,27 | - | 359 | 106 | 178 | 8,5 | 89 | 3535 | 90 | 41,9 | |
| CTD | 112 | 90 | 8B | 499,11 | 496,31 | - | 457 | 106 | 215 | 8,5 | 89 | 3535 | 90 | 70,89 | |
| CTD | 140 | 90 | 8B | 623,89 | 621,09 | - | 582 | 106 | 215 | 2 | 102 | 4040 | 100 | 74,86 | |
| CTD | 144 | 90 | 8B | 641,71 | 638,92 | - | 600 | 106 | 215 | 2 | 102 | 4040 | 100 | 82,52 | |
| CTD | 168 | 90 | 11B | 748,66 | 745,87 | - | 705 | 106 | 267 | 10,5 | 127 | 5050 | 100 | 109,24 | |
| CTD | 192 | 90 | 11B | 855,61 | 852,82 | - | 812 | 106 | 267 | 10,5 | 127 | 5050 | 100 | 126,05 | |
| CTD | 216 | 90 | 11B | 962,57 | 959,77 | - | 920 | 106 | 267 | 10,5 | 127 | 5050 | 100 | - | |
| CTD | 264 | 90 | 11B | 1176,47 | 1176,47 | - | 1133 | 106 | 395 | 10,5 | 127 | 6050 | 125 | - | |

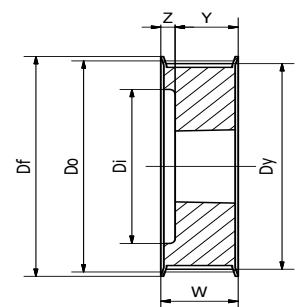

4

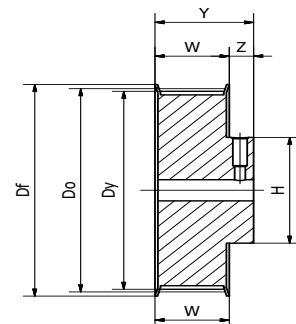

4C

| 14M125 | | | | | | | | | | | | | | | |
|---------|-----------------|-----------------|-----------|---------|---------|---------|---------|--------|--------|--------|--------|------------|---------------|-------------|----------|
| Profile | Number of teeth | Belt width [mm] | Execution | Do [mm] | Dy [mm] | Df [mm] | Di [mm] | W [mm] | H [mm] | Z [mm] | Y [mm] | Taper bush | Max bore [mm] | Weight [kg] | Material |
| CTD | 38 | 125 | 4 | 169,34 | 166,54 | 177 | 130 | 141 | - | 32,5 | 76 | 3030 | 75 | 11,74 | GS400 |
| CTD | 40 | 125 | 4 | 178,25 | 175,45 | 186 | 38 | 141 | - | 32,5 | 76 | 3030 | 75 | 12,23 | |
| CTD | 44 | 125 | 5 | 196,08 | 193,28 | 209 | 154 | 141 | - | 26 | 89 | 3535 | 90 | 14,46 | |
| CTD | 48 | 125 | 5 | 213,9 | 211,11 | 216 | 172 | 141 | - | 26 | 89 | 3535 | 90 | 14,7 | |
| CTD | 50 | 125 | 5 | 222,82 | 220,02 | 232 | 180 | 141 | - | 26 | 89 | 3535 | 90 | 20,93 | |
| CTD | 56 | 125 | 5 | 249,55 | 246,76 | 261 | 207 | 141 | - | 26 | 89 | 3535 | 90 | 25,91 | |
| CTD | 60 | 125 | 5 | 267,38 | 264,58 | 274 | 224 | 141 | - | 19,5 | 102 | 4040 | 100 | 30,92 | |
| CTD | 64 | 125 | 5 | 285,21 | 282,41 | 288 | 243 | 141 | - | 19,5 | 102 | 4040 | 100 | 35,34 | |
| CTD | 72 | 125 | 8A | 320,86 | 318,06 | - | 279 | 141 | 215 | 19,5 | 102 | 4040 | 100 | 37,71 | |
| CTD | 80 | 125 | 8A | 356,51 | 353,71 | - | 314 | 141 | 215 | 19,5 | 102 | 4040 | 100 | 42,02 | |
| CTD | 90 | 125 | 8B | 401,07 | 398,27 | - | 359 | 141 | 215 | 19,5 | 102 | 4040 | 100 | 51,29 | |
| CTD | 112 | 125 | 8B | 499,11 | 496,31 | - | 457 | 141 | 267 | 7 | 127 | 5050 | 125 | 65,64 | |
| CTD | 140 | 125 | 8B | 623,89 | 621,09 | - | 581 | 141 | 267 | 7 | 127 | 5050 | 125 | 67,9 | |
| CTD | 168 | 125 | 8B | 748,66 | 745,87 | - | 705 | 141 | 267 | 7 | 127 | 5050 | 125 | 120,66 | |
| CTD | 192 | 125 | 8B | 855,61 | 852,82 | - | 812 | 141 | 395 | 7 | 127 | 6050 | 125 | 142,39 | |
| CTD | 216 | 125 | 8B | 962,57 | 959,77 | - | 920 | 141 | 395 | 7 | 127 | 6050 | 125 | - | |
| CTD | 264 | 125 | 8B | 1176,47 | 1173,67 | - | 1133 | 141 | 395 | 7 | 127 | 6050 | 125 | - | |

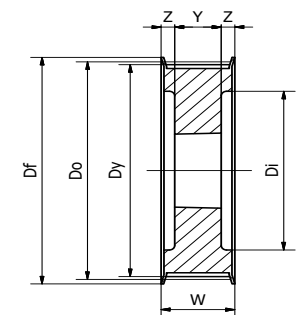

5

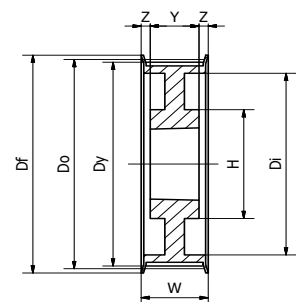

8

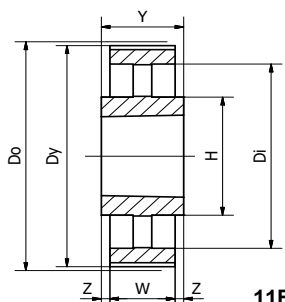

11B

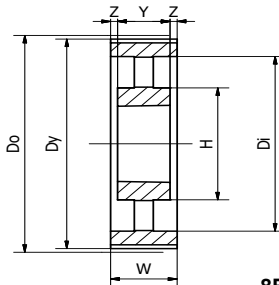

8B

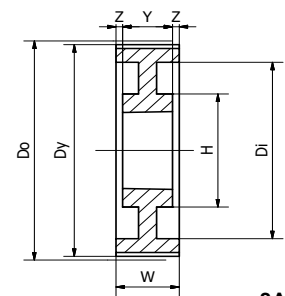

8A